

Scale: 1:20
Note: Shrubs and groundcover areas shall be bark mulched to a depth of 75mm. Mulch type as specified.

PLANT DETAILING
Shrubs spacing chart

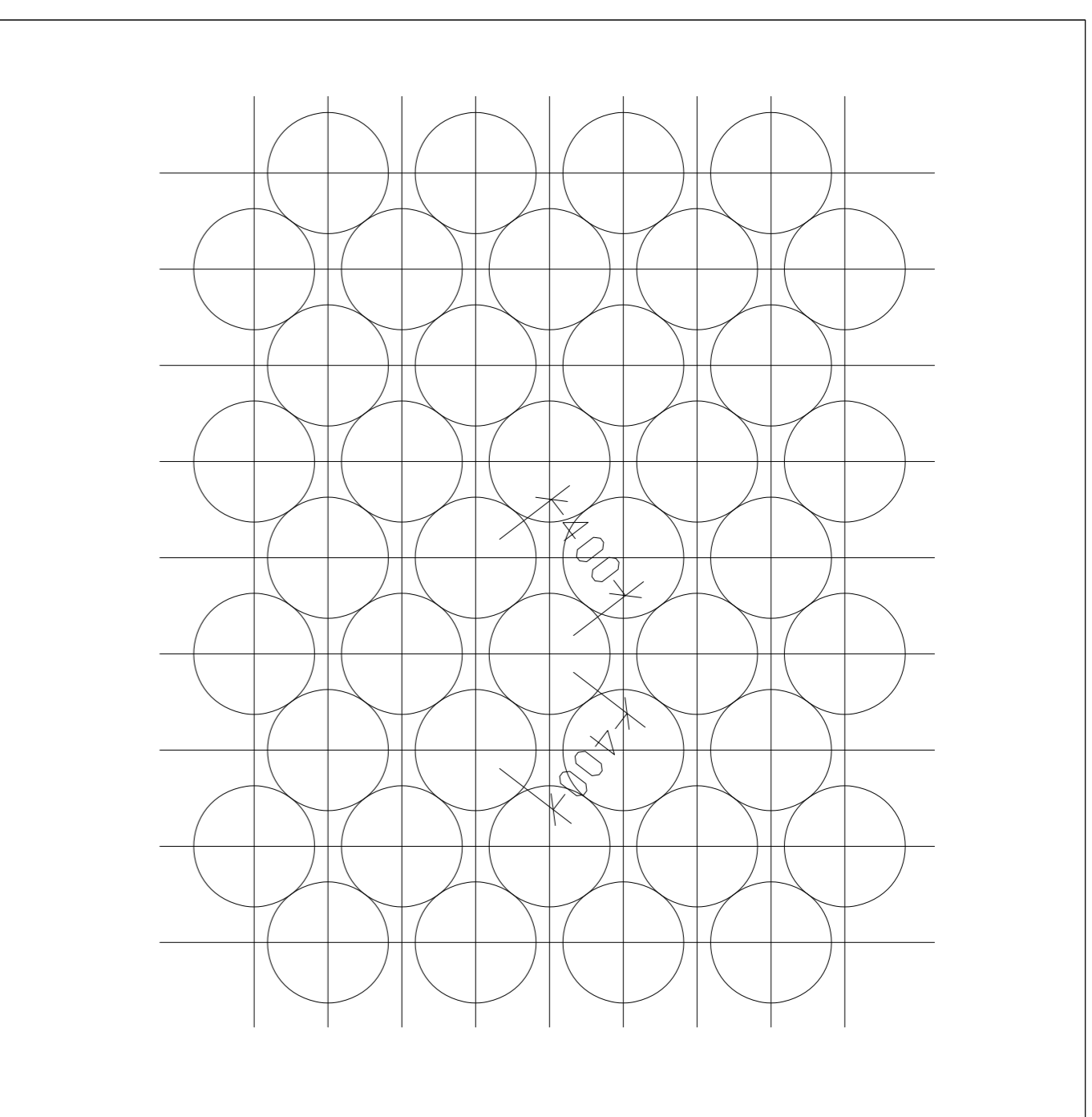

Scale: 1:20
Note: Shrubs and groundcover areas shall be bark mulched to a depth of 75mm. Mulch type as specified.

PLANT DETAILING
groundcover spacing chart

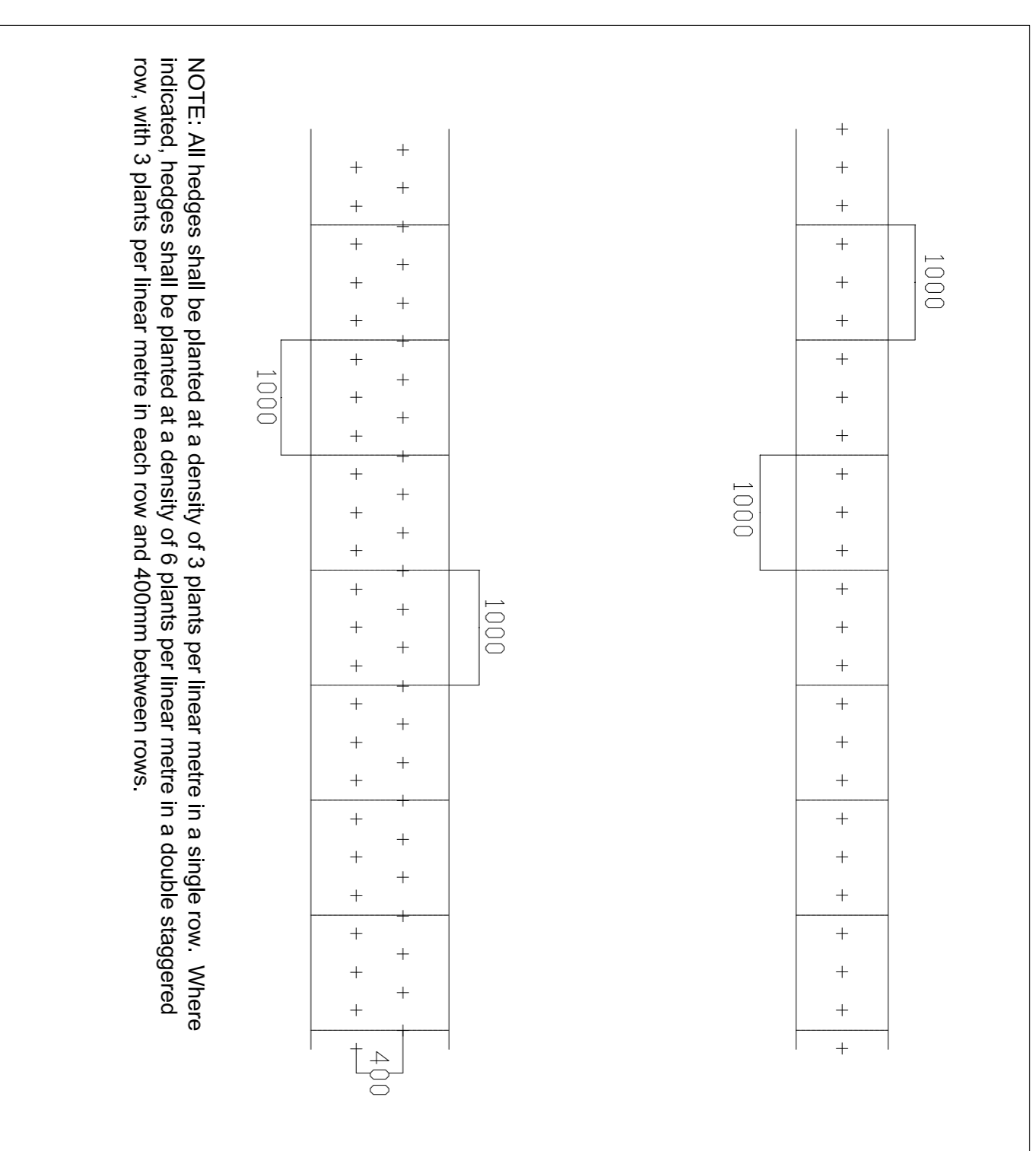

NOTE: All hedges shall be planted at a density of 3 plants per linear metre in a single row. Where indicated, hedges shall be planted at a density of 6 plants per linear metre in a double staggered row, with 3 plants per linear metre in each row and 400mm between rows.

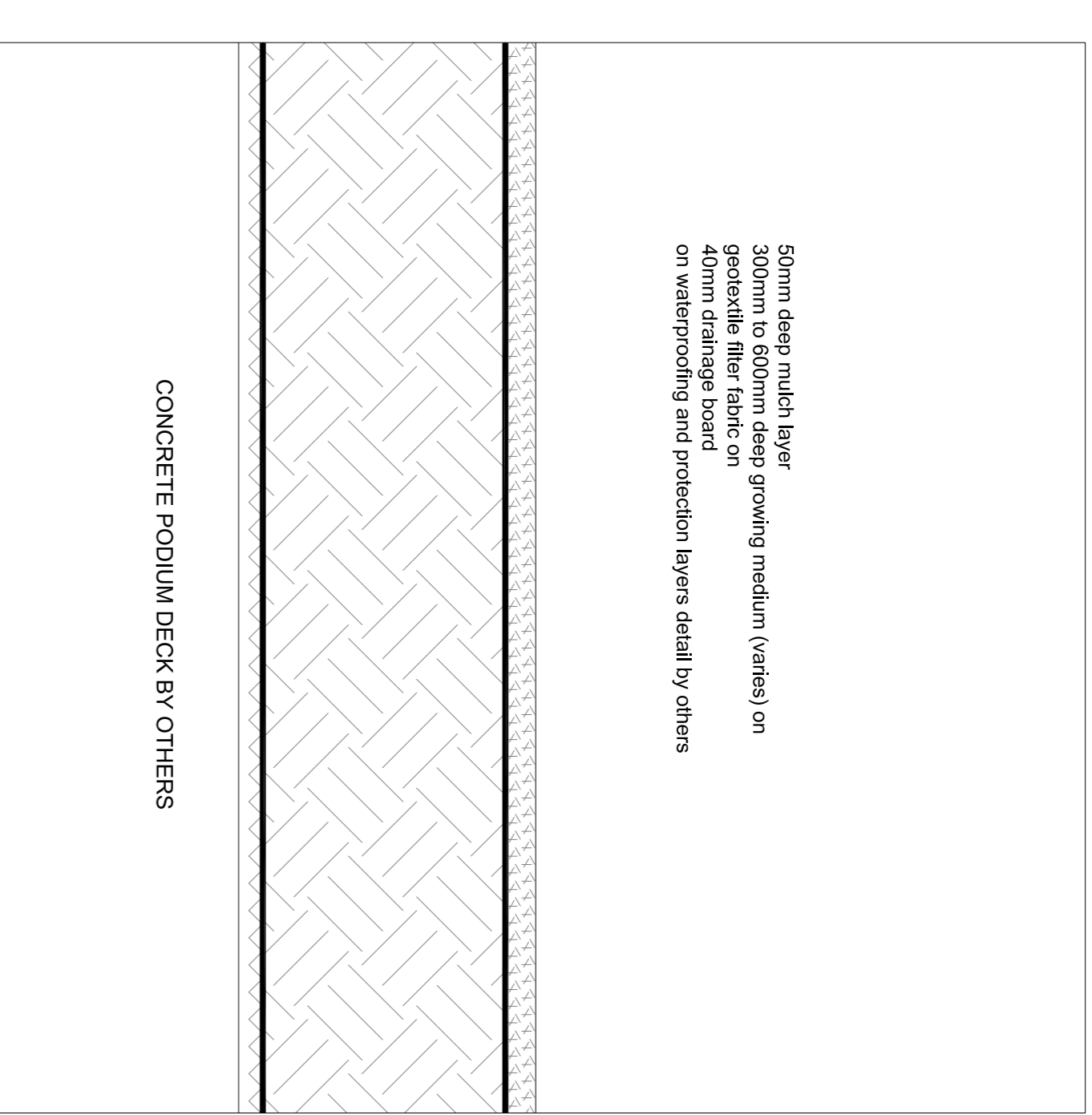

HEDGE PLANTING
spacing layout

ROOF GARDEN DETAIL
typical buildup section

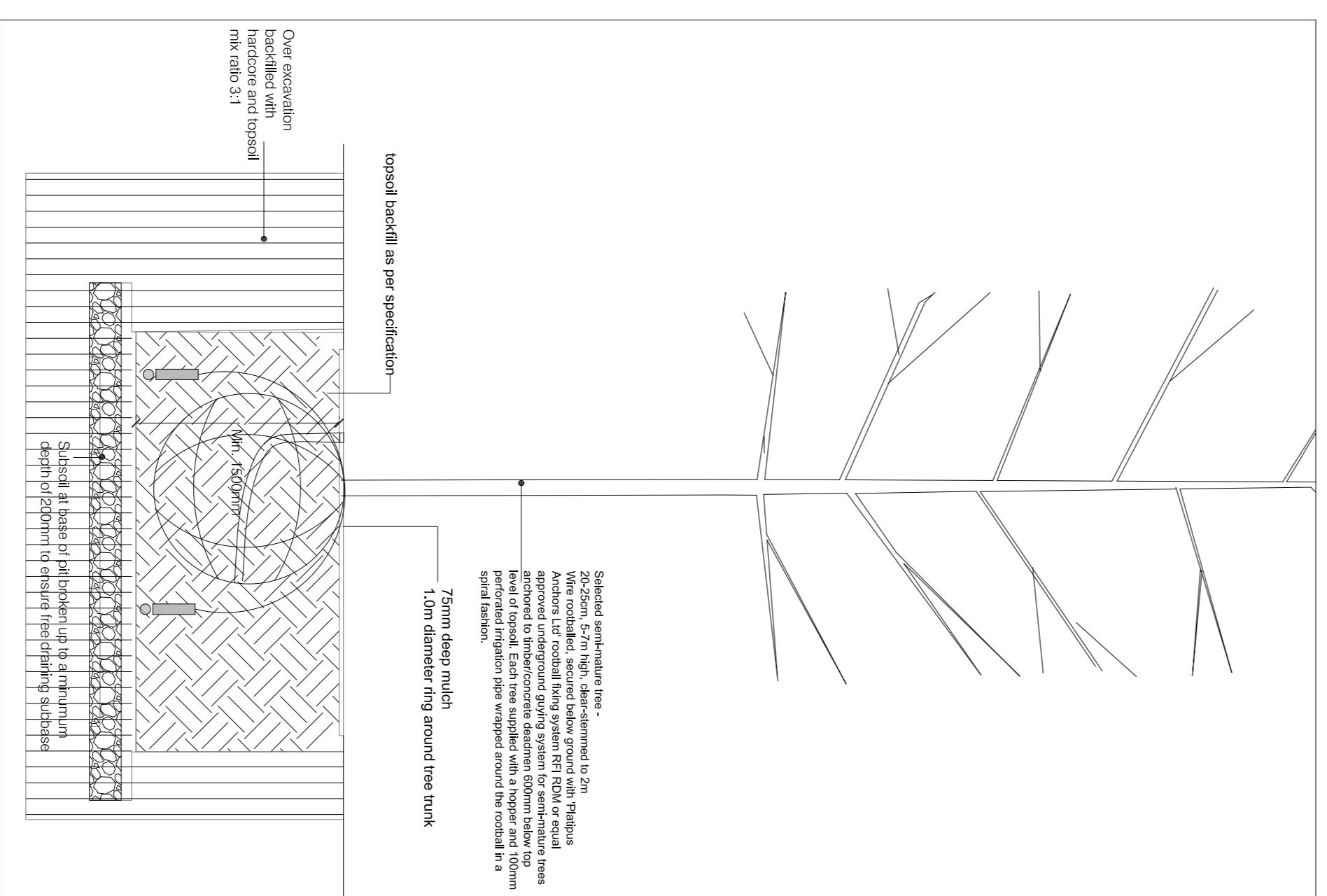

TREE PLANTING DETAIL 20-25cm girth + 30-35cm
typical planting section

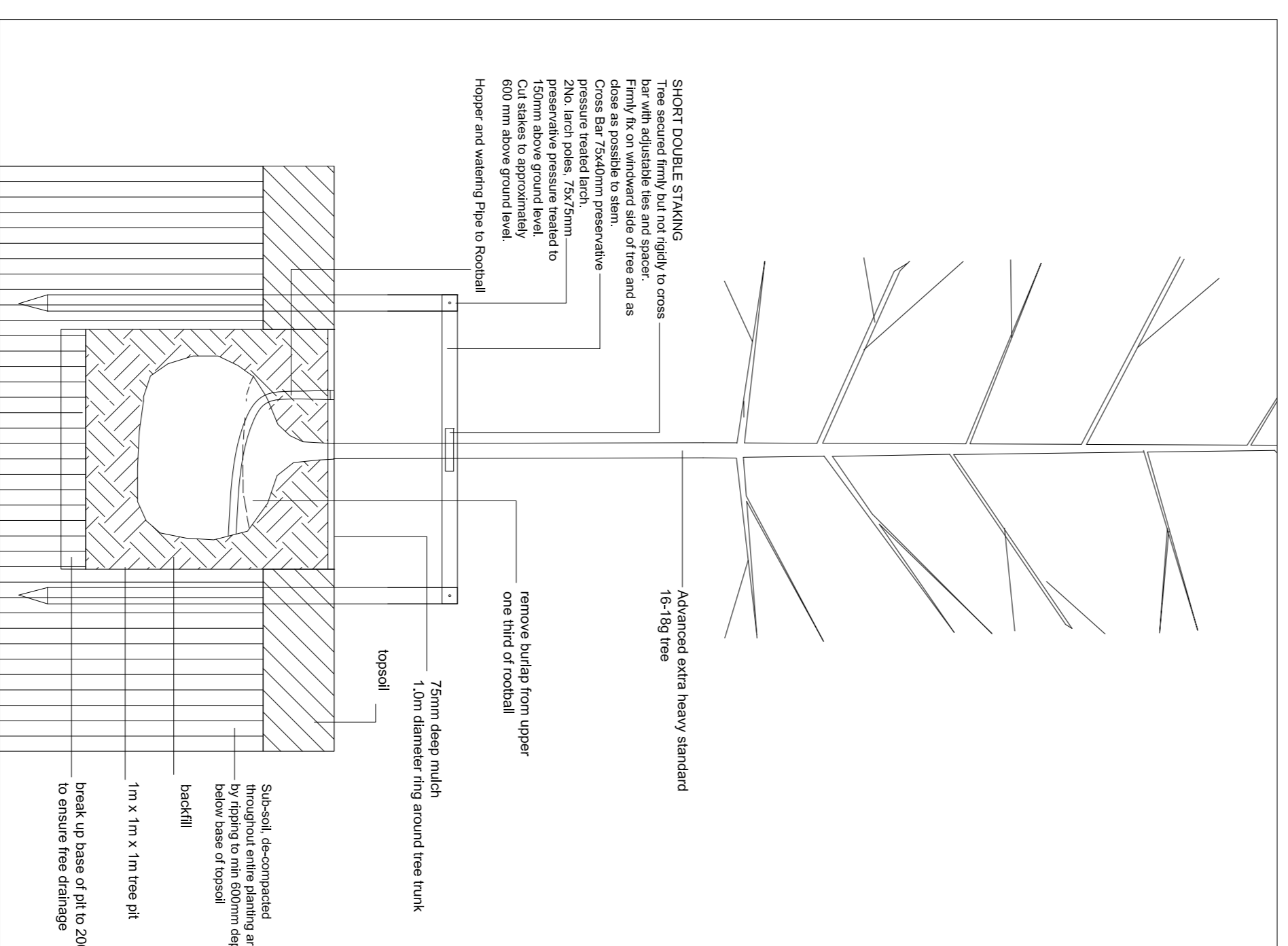

TREE PLANTING DETAIL 16-18cm
typical planting section

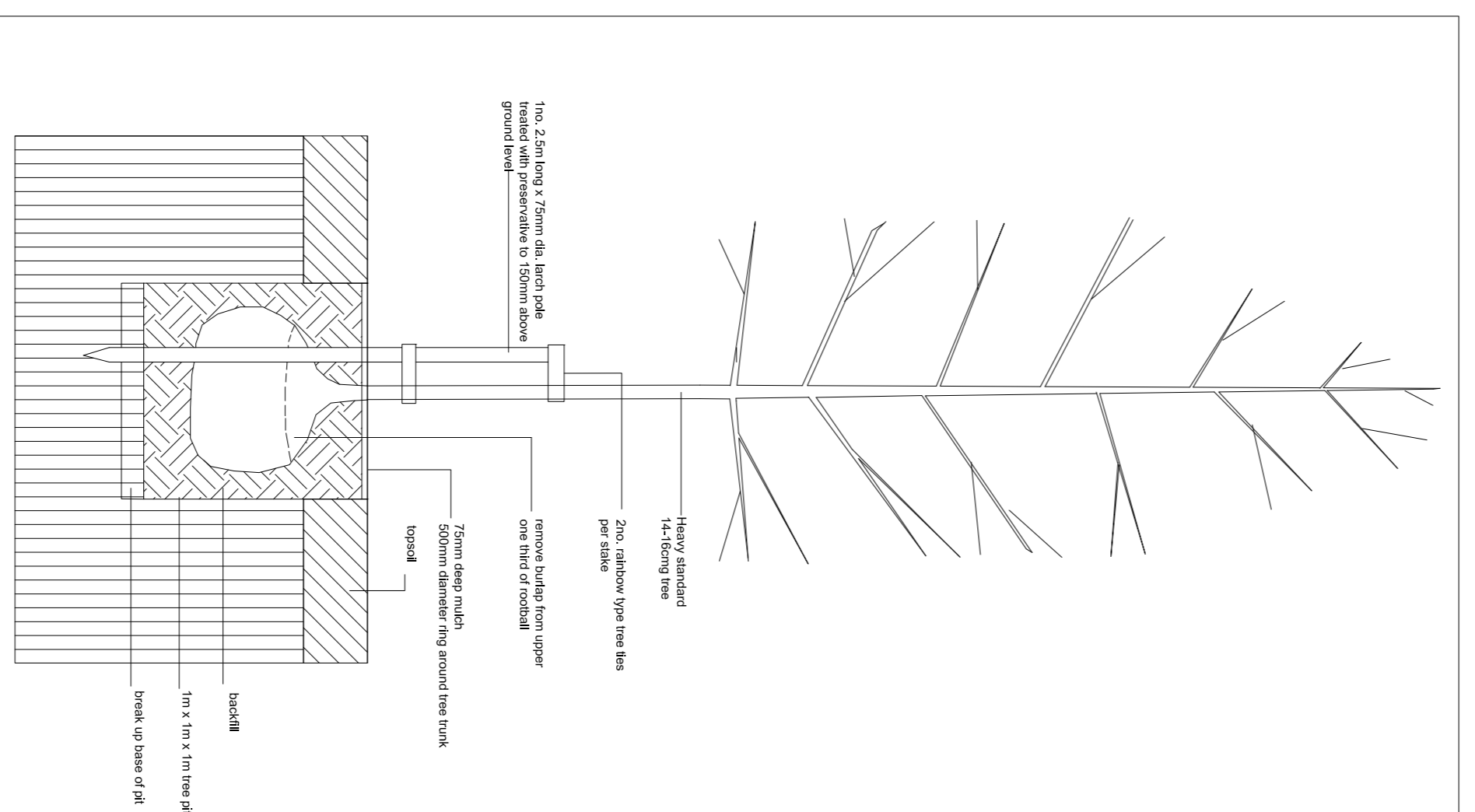

TREE PLANTING DETAIL 14-16cm
typical planting section

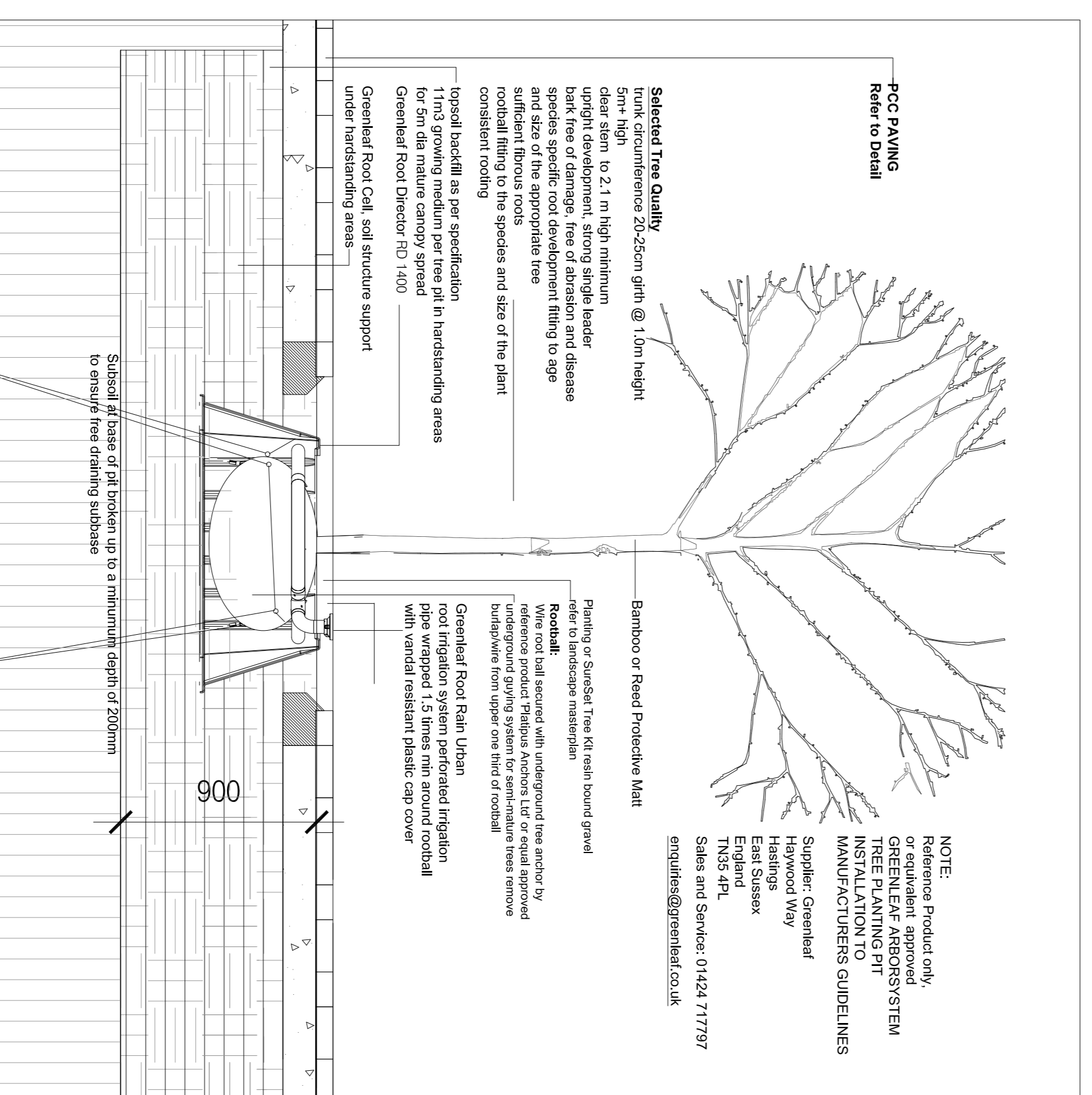

TREE PLANTING DETAIL IN HARDESTANDING AREAS
typical planting section

- NOTE: TOPSOIL DEPTH BUILDUP
- TREES 12 cu m min per tree pit in natural ground
 - 11 cu m min per tree pit in landscaping
- HEDGES 600mm depth
- SHRUBS AND GROUNDCOVERS 450mm depth
- GRASS SEEDING TURF GRASS 150mm depth

- NOTE: PODIUM ROOF GARDEN GROWING MEDIUM DEPTH BUILDUP
- GRASS SEEDING TURF GRASS 300mm depth
 - SHRUBS AND GROUNDCOVERS 450mm depth
 - HEDGES 600mm depth
 - TREES 12m cu m min

MITCHELL + ASSOCIATES		Unit 5 Woodpark, The Rise, Glasnevin Dublin 9, Ireland	
Landscape Architecture Urban Design		t + 353 1 454 6066 info@mitchell.ie	
CLIENT	HOBBESON REAL ESTATE	PROJECT:	SECTOR 3 ARENS VILLAGE STEPPASIDE DUBLIN 18
JOB NO.	LR9807	DATE:	2022/07/15
DRAWING NO.	104	SCALE:	as shown @ A1
DRAWN BY:	CELIA HARRIS	CHK'D:	CH
STATUS:	RAP PLANNING SUBMISSION	REVISION:	

NOTE: Do not scale. Use Figure Dimensions Only. All for Contractor Purpose unless Specified. Marked. © THIS DRAWING IS COPYRIGHT OF MITCHELL + ASSOCIATES