

- NOTES:**
1. THIS DRAWING IS TO BE READ IN CONJUNCTION WITH ALL OTHER RELEVANT DRAWINGS & SPECIFICATIONS.
 2. DO NOT SCALE. USE FLOURED DIMENSIONS ONLY.
 3. ALL CONCRETE IN CONTACT WITH THE GROUND TO BE MIN. STRENGTH CLASS C30/37, EXPOSURE CLASS XC3.
 4. ALL OTHER CONCRETE TO BE MIN. STRENGTH CLASS C30/37, EXPOSURE CLASS XC3.
 5. ALL FOUNDATIONS TO BE PLACED ON GRADE C30/37 CONCRETE BLINDING TO GOOD GROUND.
 6. ALL STRIPS TO BE CENTRED ON 215 WALLS
 7. ALL ELEMENTS ARE STRUCTURAL.
 8. ALL COLUMNS CASTED ON 215 WALLS (U.N.O.)
 9. ALL LOAD BEARING BLOCKWORK TO BE SOLID
 10. ALL STEEL TO BE GRADE S275 STEEL (U.N.O.)
 11. ALL BOLTS TO BE GRADE 8.8 BOLTS (U.N.O.)
 12. ALL WELDS TO BE FIRM FILLET WELDS (U.N.O.)
 13. ALL BLOCKWORK TO BE STU (U.N.O.)

RC COLUMN SCHEDULE			
REF.	SIZE	REF.	SIZE
C1	1000 X 300 RC COLUMN	-	-

RAFT FOUNDATION

THE SELECTION OF THE CURRENT FOUNDATION PROPOSAL OF RAFF FOUNDATION IS BASED ON RESULTS OF THE SITE INVESTIGATIONS, STRUCTURAL CONSIDERATIONS AND SITE CONSTRAINTS. IF DURING EXCAVATION OF THE FOUNDATIONS AND BASEMENT UNEXPECTED GROUND CONDITIONS ARISE THAT VARY FROM THE SITE INVESTIGATIONS RESULTS, IT MAY BE NECESSARY TO AMEND THE INDICATIVE FOUNDATION SOLUTIONS PROPOSED AT THIS JUNCTURE.

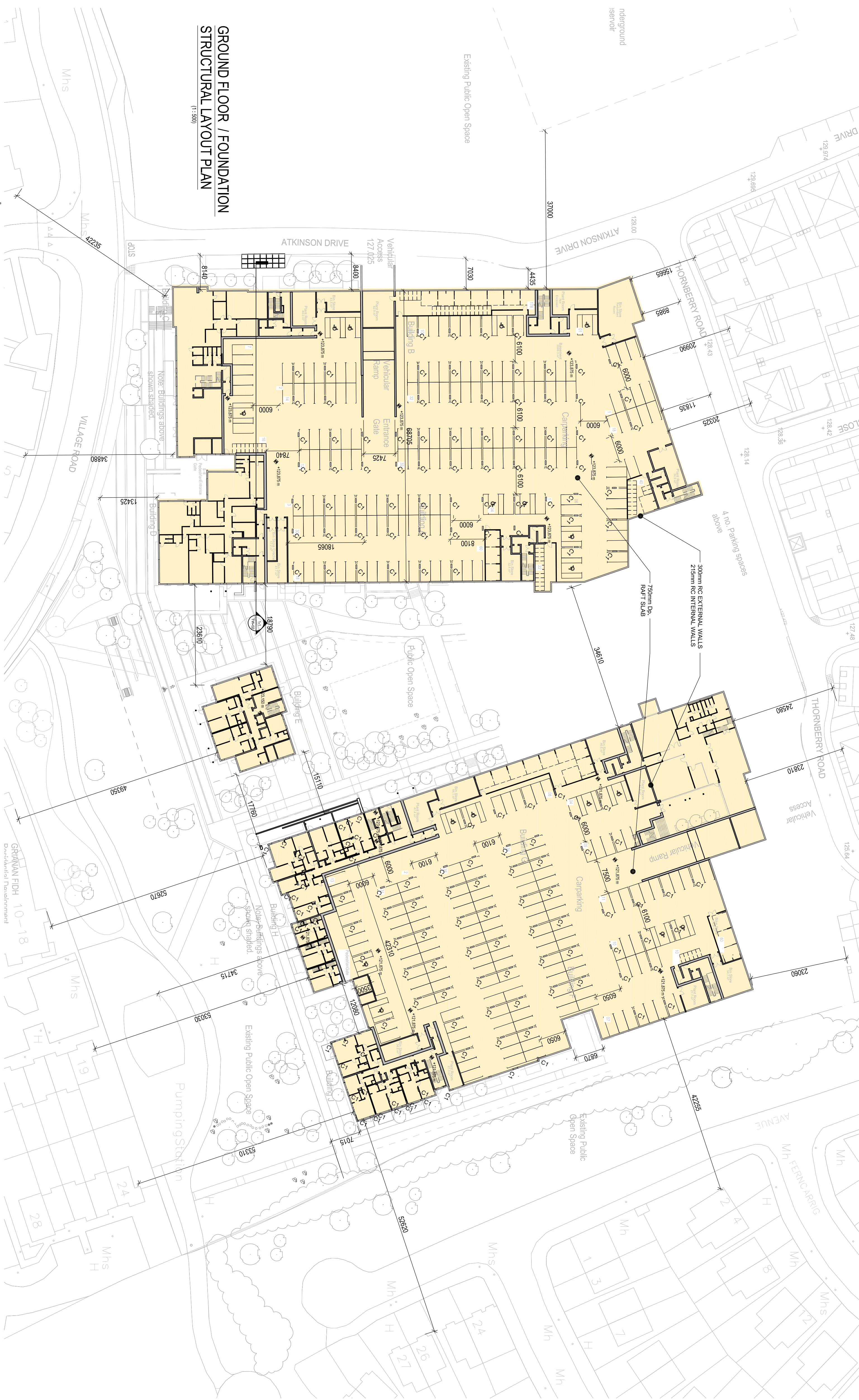

GROUND FLOOR / FOUNDATION STRUCTURAL LAYOUT PLAN

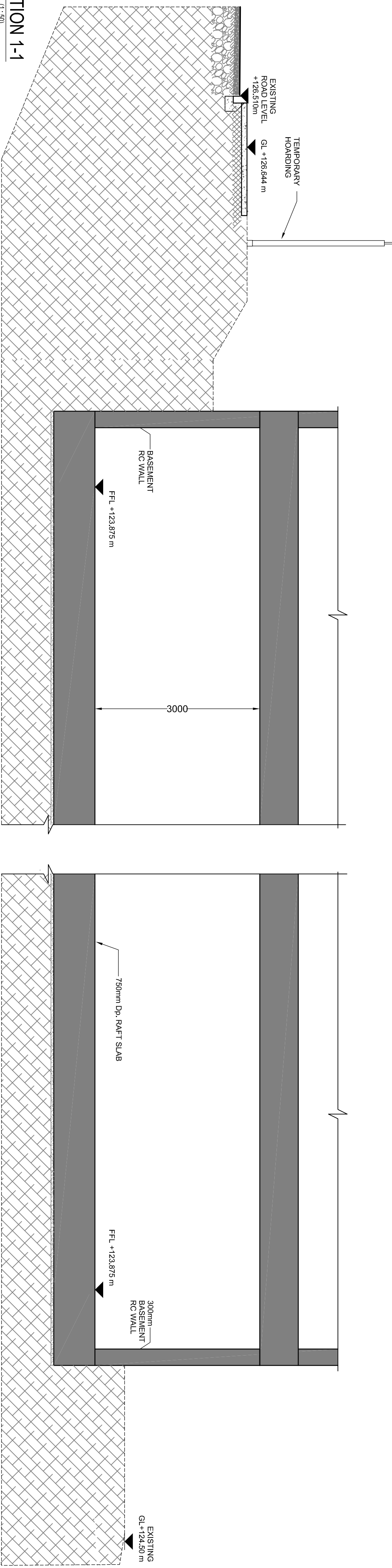

(1:50)

P.3	02/28/2027	AT	GJ	DOS	SND PLANNING ISSUE		
Mkt	Date	By	Crx.	App.	Revision		

SHD PLANNING ISSUE

Job Title

SECTOR 3
AIKEN'S VILLAGE
STEPASIDE
DUBLIN 18

Drawing Title

GROUND FLOOR / FOUNDATION

STRUCTURAL LAYOUT PLAN

FERREIRA ARCHITECTS

KAVANAGH BURKE
CONSULTING ENGINEERS

Tel. 01 - 450 0694 Unit G3, Calmount Pk.
Fax. 01 - 426 4340 Ballymount,
Email: pkavanagh@kavanaghburke.ie Dublin 12.

Email: pkavanagh@kavanaghburre.ie Dublin 12.

Y	LOS	UD

John Hb	Devin Mh	Ben
---------	----------	-----

D1636	S-1000	PL3
-------	--------	-----